



◀ 3-PHASE

Smart30

30 AMPS

The **Smart30 Series** provides ultimate power protection for Digital Production Printers and Industrial Equipment. Ideal for equipment that requires single or 3-phase and up to 30 Amps power. Along with a redundant all-modes surge protection and filtration circuit, the Smart30 Series is equipped with a Phase Sequence Monitoring circuit to detect and notify improper phase sequence connections.



SINGLE PHASE ▶

Reverse phase sequence connection may lead to malfunction and reverse rotation of the motorized parts that cause system damage in 3-phase equipment.

Smart Power Systems' **Smart30** not only protects electronic equipment against destructive power line spikes and transients, it also monitors the power line for proper phase sequence connection to ensure the equipment will function properly and perform to life expectancy.

Features:

- ▶ Redundant all modes surge protection (L-L, L-N, L-GND and N-GND)
- ▶ Transient and noise filtration
- ▶ Phase sequence diagnostics and indicators (3-phase model only)
- ▶ Power lines (L1,L2 and L3) indicators
- ▶ Fault internal LED indicators
- ▶ Easy connection plug and receptacle
 - No hardwire needed
- ▶ High surge current capacity
- ▶ Including models for 30 Amp single phase, 3-phase, 120V / 240V power line configuration

Benefits of Power Protection:

- ▶ Reduce downtime, error codes, "no problem found" service calls
- ▶ Protect connected equipment against the most severe spikes, surges, prolonged over voltage and ground loop currents
- ▶ Extend the life of connected equipment

Ideal for:

- ▶ Industrial digital printers
- ▶ 3-phase digital copiers
- ▶ Telecom systems
- ▶ 30 Amp industrial equipment



If the Smart Power Systems equipment fails and this failure allows a surge to pass through and damage the connected equipment, Smart Power Systems will pay for the repair or replacement of the connected equipment up to \$25,000.

SINGLE PHASE

FRONT VIEW



REAR VIEW

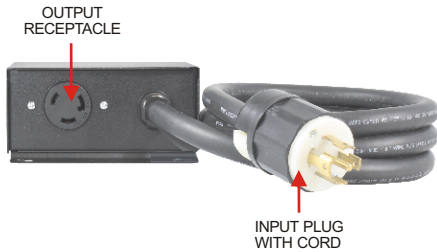

3-PHASE

FRONT VIEW

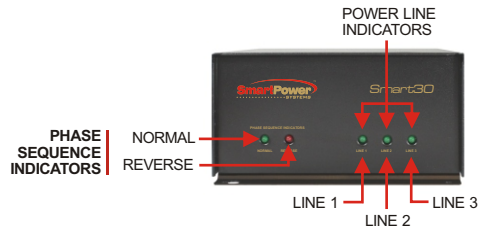

REAR VIEW

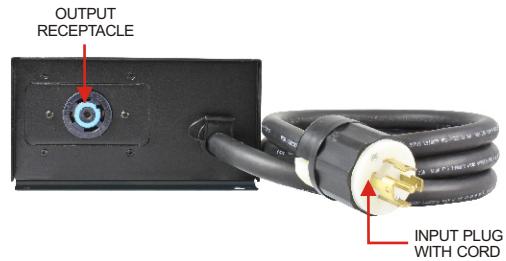

Specifications

	S301P120-01	S301P240-01	S301P120/240-01	S303P240-01	S303P120/208-01
INPUT/OUTPUT	1 phase, 120 Volts 2 wire + Ground	1 phase, 240 Volts 2 wire + Ground	Split Phase, 120/240 Volts 3 wire + Ground	3 phase 240 Volts 3 wire + Ground	3 phase 120/208 Volts 4 wire + Ground
OUTPUT CURRENT	30 Amps				
OUTPUT RECEPTACLE	L5-30R	L6-30R	L14-30R	L15-30R	L21-30R
PLUG TYPE	L5-30P	L6-30P	L14-30P	L15-30P	L21-30P
SIZE (H x W x D) (In.)				4.12 x 8.0 x 9.62	
NET WEIGHT (Lbs. / Kg.)				8.5 / 3.85	

All specifications are subject to change without notice.



A POWER QUALITY COMPANY

1-800-882-8285

1760 Stebbins Dr. • Houston, TX 77043 • Tel: 713-464-8000 Fax: 713-984-0841 • Email: sales@smartpowersystems.com • www.smartpowersystems.com